



Pick-up and delivery guide

Thank you for choosing our services!

Depending on which service you have chosen, this is a short guide to help you.

When you arrive at Kansai International Airport, please look for our staff. We always wait at an easy to find location for flight departures or arrivals.

This is the floor map of the ground floor, Terminal 1.

Pick-up and delivery point, KIX

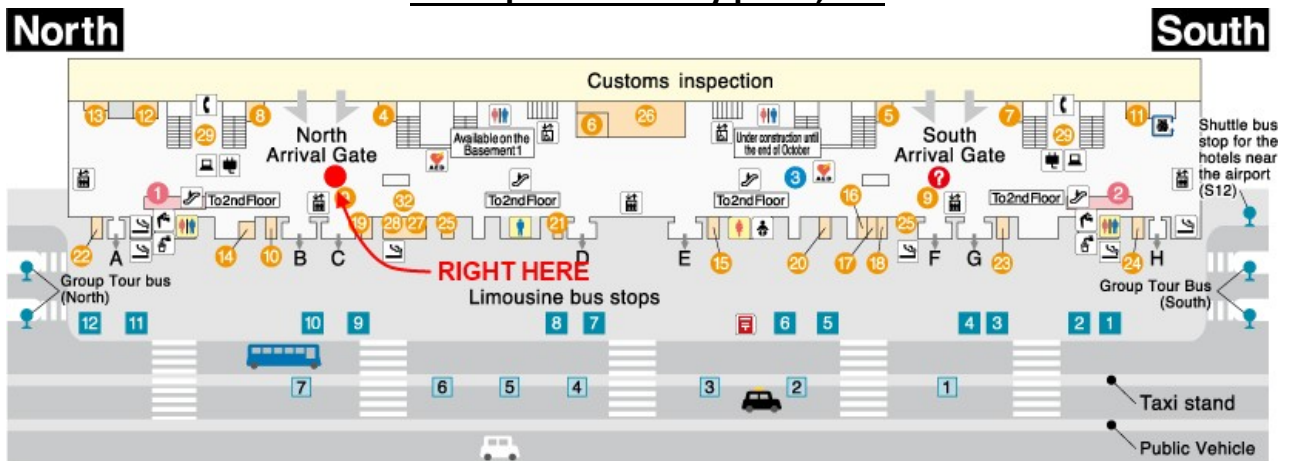

Please look out for this:

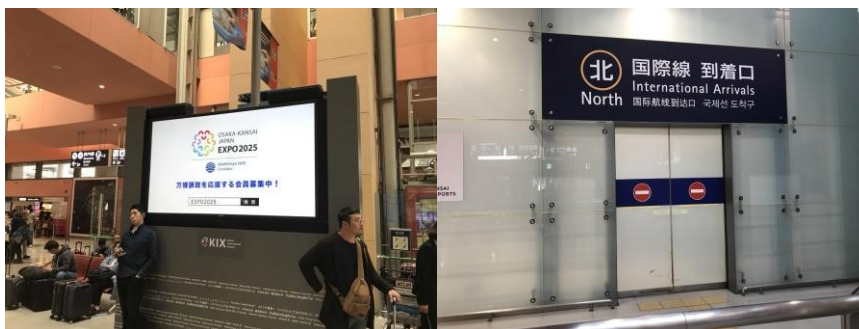

If there are any problems, please get in touch via your chosen method and we will do everything we can to help.

We collect luggage at KIX from 9:00 – 15:00, and deliver to KIX from 15:00 – 21:00 the same day.

When we deliver from KIX to your hotel, and if the hotel has a reception we will leave it with them. If it is from your hotel to KIX, please leave your luggage at the reception and notify them that we will be collecting it for you.